

BLACK WEDGE SOCKETS DIN 15 315

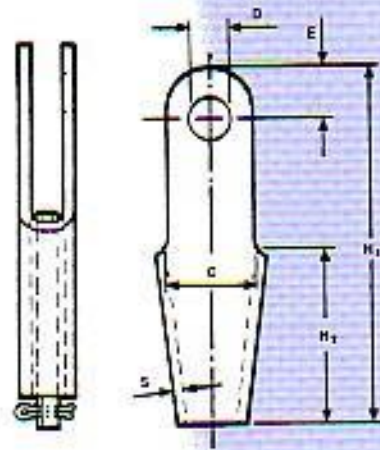

100% EFFICIENCY

Size	For Rope Diameter mm	B ₁ mm	B ₂ mm	B ₃ mm	C mm	D mm	E mm	H ₁ mm	H ₂ mm	H ₃ mm	R mm	S mm	Approximate Mass kg
4	2-4	8	8	7	17	7	12	66	30	37	12.5	2.5	0.25
5	4-5	12	12	10	33	10	16	110	60	68	9.5	3	0.35
8	6-8	12	14	11	37	12	20	150	75	92	12.5	4	0.57
11	9-11	15	17	14	48	16	26	190	95	117	16	6	1.05
14	12-14	20	22	18	58	18	32	230	115	141	19	8	1.89
17	15-17	23	25	21	70	22	36	260	130	162	23	10	3.26

FITTING

When fitting the rope to the socket, as much slack as possible should be removed from the system in order to maximise the available eye bolt adjustment. The load should then be applied to the assembly and the wedge observed to seat correctly in the socket body.

A single DIN 1142 wire rope grip should then be fitted across the two parts of rope near to the socket body. This ensures that the wedge cannot become displaced in a slack rope condition.

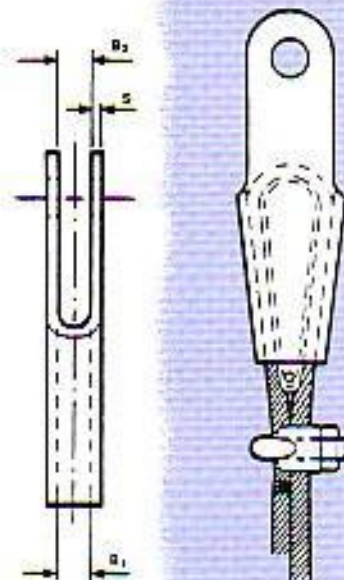
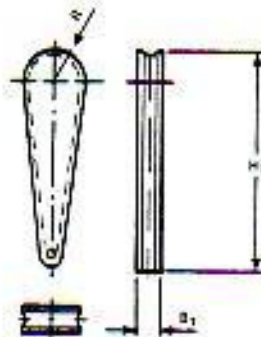

HALL STAGE